

THE
NATIONAL
GALLERY



YOUR EVENT AT
THE NATIONAL GALLERY

📞 +44 20 7747 5931 · ✉ venue.hire@nationalgallery.org.uk · 📱 @ngevents



THE GALLERY

Let your event tell a timeless story in one of London's most iconic historic locations.

From Van Gogh's bold brushstrokes to Monet's enchanting landscapes, your event will be set against the backdrop of masterpieces that have shaped history and culture, a one-of-a-kind experience leaving lasting memories for you and your guests.

By hosting your event with us, you will also support our key objectives to enhance and care for the collection and provide free access for generations to come.



THE PORTICO

Standing 100

[Page 4](#)



CENTRAL HALL

Standing 200
Seated 100

[Page 5](#)



THE BARRY ROOMS

Standing 300
Seated 150

[Page 6](#)



ROOM 32 THE JULIA & HANS RAUSING ROOM

Standing 450
Seated 300

[Page 7](#)



ROOM 34 THE BRITISH COLLECTION

Standing 350
Seated 270

[Page 8](#)

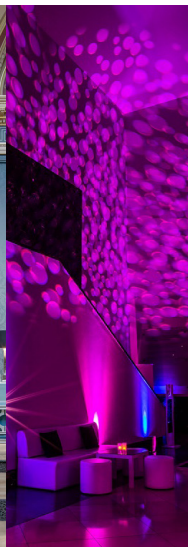

ANNENBERG COURT

Standing 200

[Page 9](#)



THE YVES SAINT LAURENT ROOM

Standing 100
Seated 60

[Page 10](#)



THE WOHL ROOM

Standing 450
Seated 300

[Page 11](#)

THE PORTICO

In the heart of London, overlooking Trafalgar Square, our Portico Terrace promises unforgettable moments, expertly tailored to leave an unforgettable mark on any event. Framed by majestic columns and adorned with exquisite mosaic floor tiles, it offers one of London's finest viewpoints, capturing the city's eternal charm and rich heritage.

Embrace alfresco dining or elevate your occasion with a sophisticated drinks reception on a delightful summer evening. Our Portico Terrace stands proud, providing your guests with the ultimate experience to watch the coming and goings of buzzing London life.

Standing 100

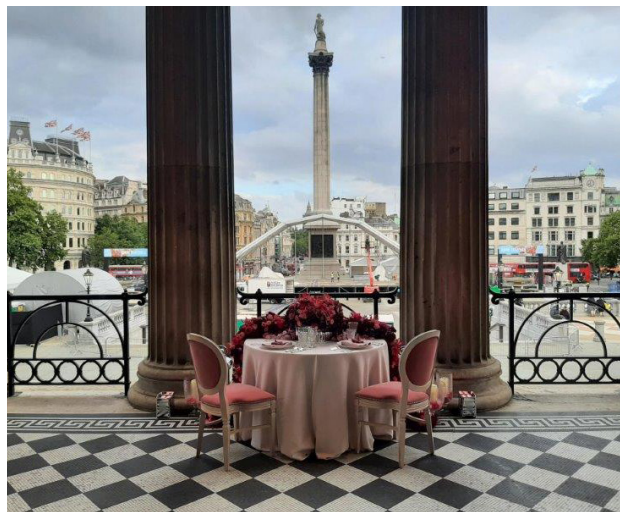
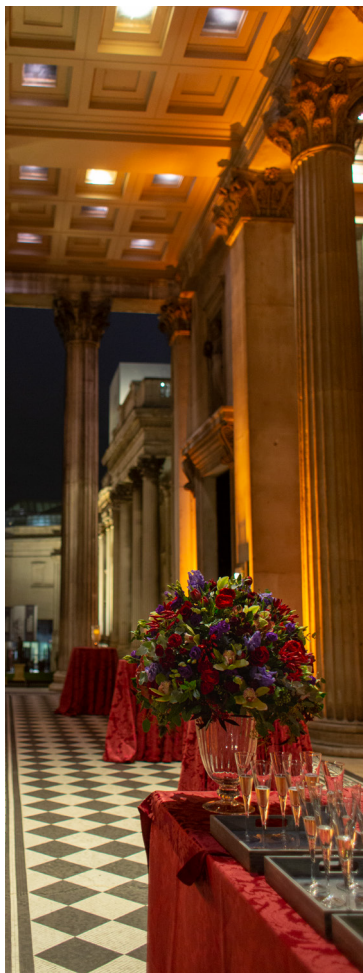
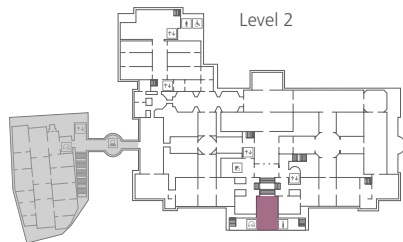



© James Everett Photography



© FBP Photography

CENTRAL HALL

The impressive Mosaic Terrace and marble stairway lead the way to the spectacular Central Hall. Defined by an elevated glass ceiling and beautifully lined with rich red walls, Central Hall is a wonderful location to welcome your guests with an elegant drinks reception before heading to dinner in one of the adjacent rooms or for a delightful breakfast before an exciting out-of-hours tour.

Standing 200 · Seated 100

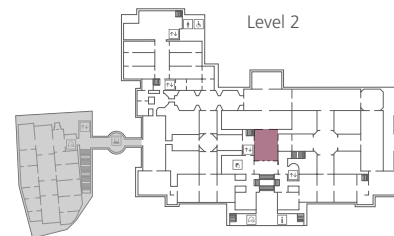

Level 2

THE BARRY ROOMS

As you step inside, majestic domed ceilings, meticulously crafted marble pillars, and a treasure trove of unparalleled masterpieces welcome you into our most opulent event space.

With its versatile layout – whether it is a charming piano solo providing a soothing backdrop to an intimate dinner, or a sophisticated circular bar setting the stage for a buzzing drinks reception – you can tailor the setting to your event.

Standing 300 · Seated 150

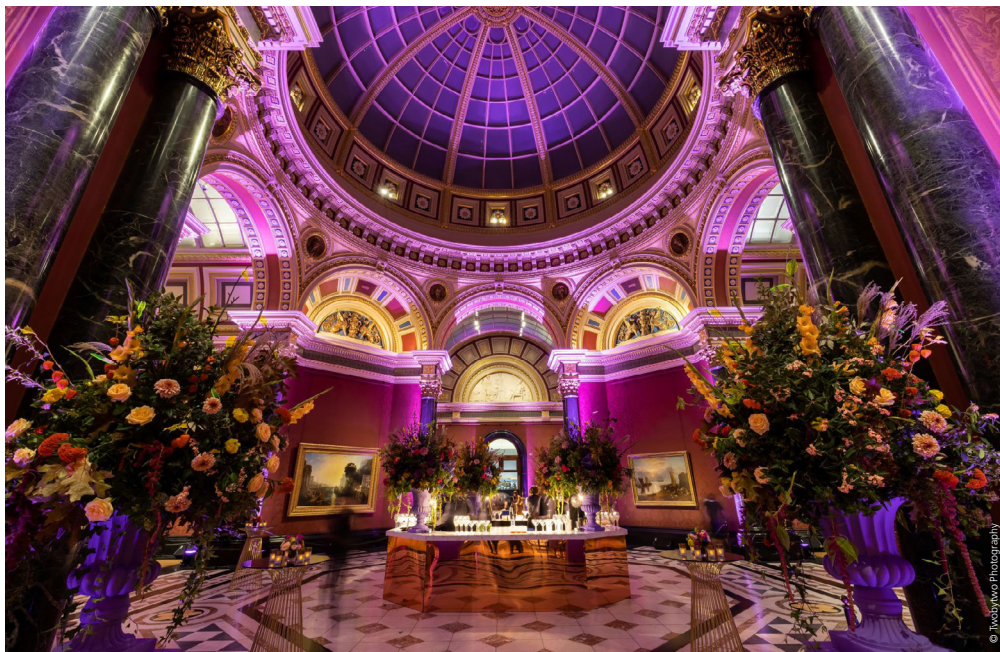
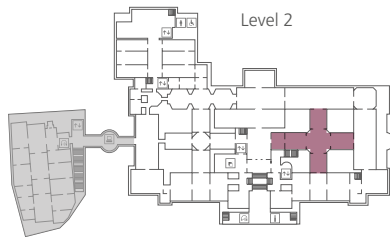



ROOM 32 THE JULIA AND HANS RAUSING ROOM

An Italian palazzo boasting mesmerising Baroque masterpieces by Caravaggio and many others.

Immerse yourself in an atmosphere of intensity and intrigue, making this space a setting for dinners and celebrations that will leave a lasting impression on your guests. With the option to connect it to the grandeur of the Barry Rooms, this space sets the stage for spectacular drinks receptions, accommodating up to 700 guests.

Standing 450 · Seated 300

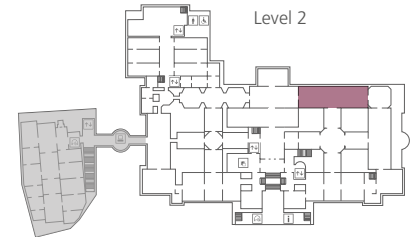

ROOM 34

THE BRITISH COLLECTION

Experience the splendour of 18th-century British society as you enter Room 34. The walls adorned with exquisite shades of blue provide an elegant backdrop for our finest British paintings, including works by renowned artists like Turner, Constable, and Stubbs.

This versatile rectangular space effortlessly adapts to suit the requirements of your event, be it a laid-back drinks reception or a Bridgerton-esque dinner filled with sophistication. And for those seeking an even grander affair, the adjoining Barry Rooms can be seamlessly connected to Room 34, accommodating an impressive guest list of up to 700 people.

Standing 350 · Seated 270

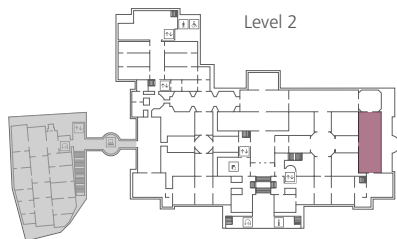



ANNENBERG COURT

Conveniently accessible from our galleries, Annenberg Court stands as our most versatile space. Embrace the modernity of this setting to celebrate a wide range of occasions, from smaller receptions to vibrant afterparties and DJ-sets.

It is a blank canvas ready to be transformed to suit any event and guarantees a memorable conclusion to your evening.

Standing 200

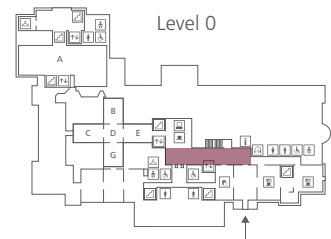

THE YVES SAINT LAURENT ROOM

The Yves Saint Laurent Room is an elegant gallery dedicated to Rubens, the most celebrated Flemish painter of the 17th Century. In addition to the ingenuity of his compositions and brilliant use of colour, the opulent fabric on the walls enhances the atmospheric setting.

Guided tours can also be arranged of paintings by artists including Rembrandt and Van Dyck in the adjacent rooms.

Standing 100 · Seated 60

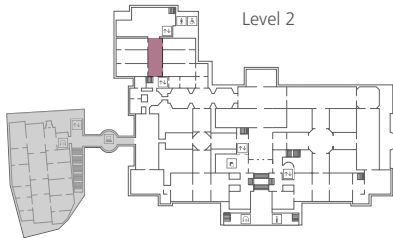



THE WOHL ROOM

The Wohl Room is one of our largest event spaces and it bridges our elegant 1838 building with our new more contemporary Sainsbury Wing. The opulent Wohl Room has the Gallery's impressive collection of Venetian paintings by artists including Titian, Veronese, Tintoretto and Bassano, all hung against lavish damask walls and under a spectacular glass ceiling.

Standing 450 · Seated 300

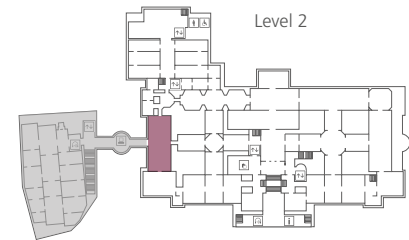

NEW SPACES COMING SOON

In May 2024, we celebrated our 200th birthday. To commemorate this occasion, we are undergoing an ambitious capital transformation: NG200.

To mark this milestone, we are creating a meaningful legacy that will make the Gallery fit for purpose as it enters its third century.

We are reimagining our entrance and creating an exciting new Supporters House. This also comes with a full redesign of our daytime events spaces due to be completed in 2025. From our popular auditorium to a flexible meeting room and many more versatile event spaces, there is much to look forward to in 2025. Take a look!





THE PIGOTT THEATRE

Our auditorium is returning with exciting brand new equipment and a design refresh. With the help of a dedicated team of Audio-Visual Technicians, this 300 theatre style seat auditorium can be hired for presentations, conferences, film screenings, award ceremonies, product launches and more.

We have an adjacent versatile foyer to provide space for refreshment breaks, a light lunch during and toasting the end of the event with a networking reception.



THE WHITCOMB ROOM

On the mezzanine level, we have a versatile space for team activities, private business lunches and full-day board meetings.

It offers AV facilities, including a projector, screen, and a brand-new PA system, allowing you to create memorable moments, and fostering collaboration and productivity, in an environment designed to inspire.

SUPPORTERS HOUSE

As part of the NG200 project, we're transforming an existing area of the main National Gallery building into a space for Supporters and Members to relax, socialise and enjoy a deeper connection.

The Supporters House will also be available for private hire out of hours and will suit more intimate gatherings, such as special occasion events and corporate entertaining for up to 100 people. It will have its own restaurant, bar, private dining room, lounge and event space. The event space will also be available during the day for venue hire. This space will be conveniently located with private access from Trafalgar Square.





BESPOKE TOURS AND EXPERIENCES

Immerse yourself in the captivating narratives and explore the stories behind our world-famous masterpieces by booking a bespoke private tour.

With our team of expert guides and art historians, we can plan an experience that caters to your precise interests. Each tour is thoughtfully curated to align with your preferences, ensuring a personalised journey through the realms of artistic expression and history.

Our private tours offer a flexible range of options. As stand-alone experiences, they grant private access to the Gallery's treasures for the duration of up to 1 hour and suitable for up to 30 guests. These tours can also be seamlessly integrated as an addition to your event, whether it is a breakfast or evening gathering.

You can make the most of your venue hire experience at the National Gallery by letting your guests interact with the art historians, following the structure of a tour or at their own pace. For a more creative experience, organise a sketch workshop for you and your guests, so you can enjoy the peace of the Gallery out of hours and get lost in your surroundings.





EXHIBITIONS AND CORPORATE MEMBERSHIP

For the past 200 years, the National Gallery has been championing art for all, with an extensive track record of incredible exhibitions featuring works from the collection and loans of acclaimed masterpieces. With our gaze set towards our third century, for 2024, we are planning a programme of inspirational exhibitions and outreach around the country and the world that aim to exceed expectations, such as the upcoming major Van Gogh exhibition.

As a Corporate Member or Sponsor, you will gain access to private viewings of our internationally acclaimed temporary exhibitions, as well as exclusive benefits and special invites to Gallery-hosted events.

More information is available [here](#).

PRICING

Our Gallery spaces are available for hire from 8am until 10am for breakfast events and morning tours. In the evening, set-up can begin at 6pm, following the closure of the Gallery to the public.

GALLERY HIRE

Breakfast	from £7,000 + VAT
Reception/Dinner	from £18,000 + VAT
Annenberg Court	£2,000 per hour + VAT (as an after-party space following your reception or dinner in the other rooms)
Filming	quote on request

TOURS

Weekday morning	from £3,000 + VAT (packages inclusive of catering available)
Weekday evening	from £3,500 + VAT (packages inclusive of catering available)
Weekend	from £4,000 + VAT
Sketch workshop	£5,000 per hour + VAT (packages inclusive of catering available)



ACCREDITED SUPPLIERS

When the doors close at 6pm, it's time to transform the Gallery for your event. From sumptuous catering to immersive entertainment, choose from our wide selection of hand-picked expert suppliers to create a memorable event.

Explore our supplier options [here](#).



AN ICONIC LANDMARK & LOCATION

Situated in the heart of central London, the National Gallery is located within easy reach by public and private transport.



Step-free access is available via the Getty entrance.



THE NATIONAL GALLERY

Our dedicated Events Team would love to welcome you to the National Gallery and show you our stunning spaces. Contact us to book a viewing!

📞 +44 20 7747 5931

✉️ venue.hire@nationalgallery.org.uk

📷 @ngevents

© The National Gallery, London. National Gallery Global Limited, London.

nationalgallery.org.uk/venue-hire

